

HOMER TOWNSHIP SECTION 12 R13 TWP 7 MORGAN COUNTY, OH

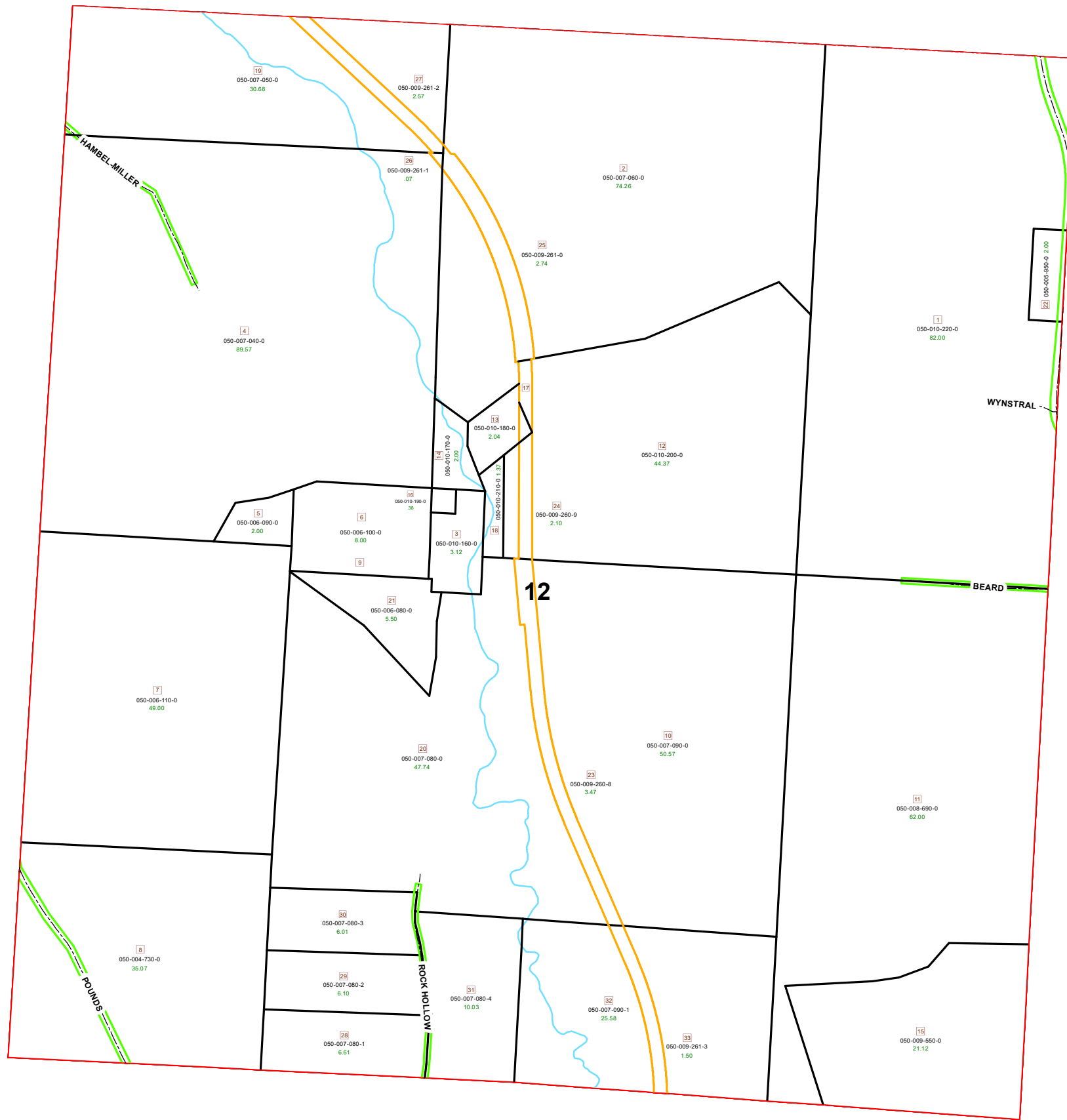

PIN	VOL	PAGE	Owner	LegalDescr	Acres
050-007-080-1	OR32	132	CRITES DAVID N & KAY J	R13 T07 S12 SD 28	6.613
050-009-261-3	OR32	590	CRITES JOSEPH C ET2AL	R13 T07 S12 SD 33	1.498
050-007-080-2	OR32	132	CRITES JOSEPH C ETAL	R13 T07 S12 SD 29	6.096
050-007-090-1	OR32	132	CRITES JOSEPH C ETAL	R13 T07 S12 SD 32	25.582
050-007-080-4	OR32	132	CRITES JOSEPH C ETAL	R13 T07 S12 SD 31	10.029
050-007-080-3	OR32	132	CRITES JOSEPH C ETAL	R13 T07 S12 SD 30	6.006
050-007-090-0	OR32	126	HARVEY ANTHONY P & SHERIDA	R13 T07 S12 SD 10	50.568
050-009-260-8	OR48	428	HARVEY ANTHONY P & SHERIDA	R13 T07 S12 SD 23	3.474
050-007-080-0	OR32	126	HARVEY ANTHONY P & SHERIDA	R13 T07 S12 SD 20	47.74
050-009-550-0	OR226	2259	HEART FIELDS LLC	R13 T07 S12 SD 15	21.118
050-009-261-1	OR222	2156	JUDSON RAY	R13 T07 S12 SD 26	0.07
050-009-261-0	OR222	2153	JUDSON RAY	R13 T07 S12 SD 25	2.74
050-009-261-2	OR222	2150	JUDSON RAY	R13 T07 S12 SD 27	2.57
050-004-730-0	OR207	1539	KOVACH ANDREW	R13 T07 S12 SD 8	35.071
050-007-060-0	OR215	94	METKA TONIA LYNN & KENNETH AL	R13 T07 S12 SD 2	74.26
050-007-040-0	OR215	94	METKA TONIA LYNN & KENNETH AL	R13 T07 S12 SD 4	89.57
050-007-050-0	OR215	94	METKA TONIA LYNN & KENNETH AL	R13 T07 S12 SD 19	30.68
050-006-080-0	OR226	1668	SKIVER LINDA S & MICHAEL J	R13 T07 S12 SD 21	5.5
050-006-110-0	OR226	1668	SKIVER LINDA S & MICHAEL J	R13 T07 S12 SD 7 S	49
050-006-090-0	OR226	1668	SKIVER LINDA S & MICHAEL J	R13 T07 S12 SD 5 S	2
050-006-100-0	OR226	1668	SKIVER LINDA S & MICHAEL J	R13 T07 S12 SD 6-9	8
050-008-690-0	OR204	2872	SPIRES DORIS A TRUSTEE	R13 T07 S12 SD 11	62
050-009-260-9	OR222	2644	WYNSTRA ALEX M SR	R13 T07 S12 SD 24	2.1
050-010-160-0	OR182	100	WYNSTRA ALEX MICHAEL SR	R13 T07 S12 SD 3	3.12
050-010-190-0	OR182	100	WYNSTRA ALEX MICHAEL SR	R13 T07 S12 SD 16	0.38
050-010-210-0	OR182	100	WYNSTRA ALEX MICHAEL SR	R13 T07 S12 SD 17-	1.37
050-010-180-0	OR182	100	WYNSTRA ALEX MICHAEL SR	R13 T07 S12 SD 13	2.04
050-010-170-0	OR182	100	WYNSTRA ALEX MICHAEL SR	R13 T07 S12 SD 14	2
050-010-200-0	OR215	1157	WYNSTRA ALEX MICHAEL SR	R13 T07 S12 SD 12	44.37
050-005-950-0	OR189	455	WYNSTRA ALEX MICHAEL SR	R13 T07 S12 SD 22	2
050-010-220-0	OR215	1157	WYNSTRA ALEX MICHAEL SR	R13 T07 S12 SD 1	82

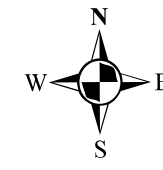

Boundaries	
-----	Hidden
-----	Roads
-----	County
-----	Parcel
-----	Lot
-----	Township
-----	Section
-----	Parcels
-----	ROW
-----	Hydro

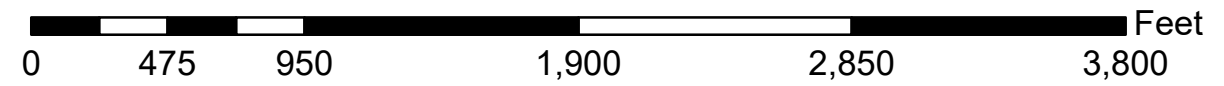

Disclaimer: The information that these maps contains is for reference purposes only. Please bring any erros to the attention of the Engineer's Office staff.
Thank you

Source: Morgan County Engineer's Office
Author: Marcia Wolfe
Date: 6/5/2020